

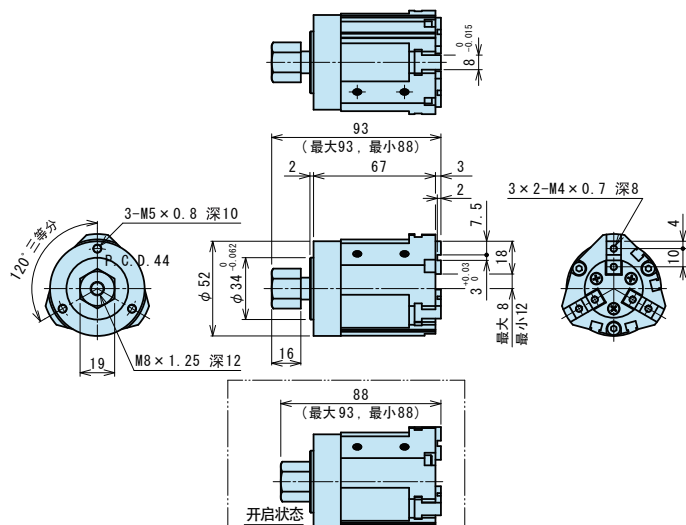

## 外形图

### CKL-32A-FC (最适合夹持力150N~320N)

#### CLK-32A-FC 标准



### CKL-40A-FC (最适合夹持力250N~450N)

#### CLK-40A-FC 标准

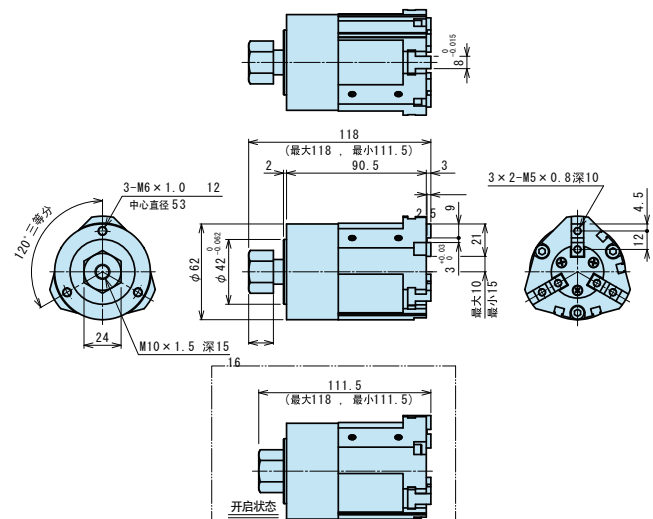

### BHA-01A-FC (最适合夹持力25N~39N)

#### BHA-01A-FC 标准

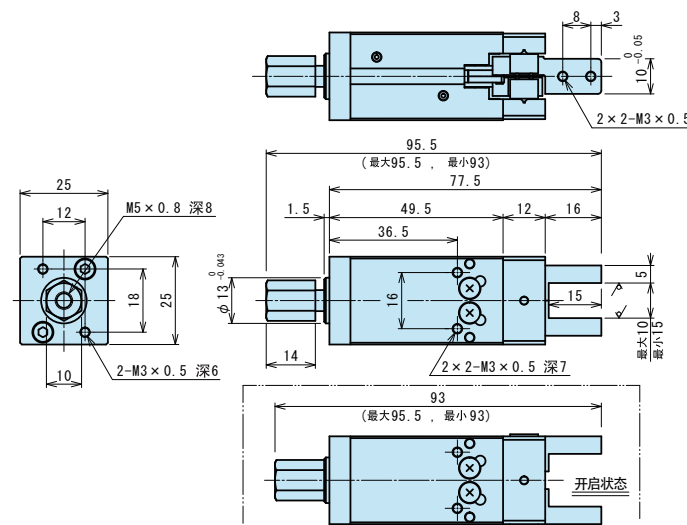

### BHA-03A-FC (最适合夹持力40N~75N)

#### BHA-03A-FC 标准

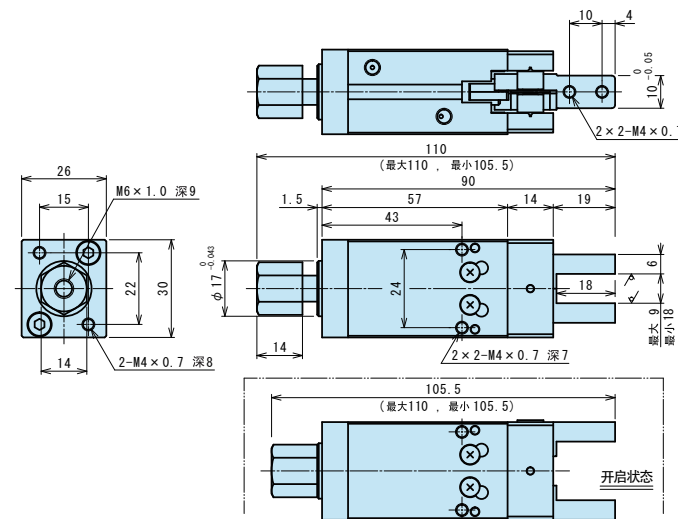

无尘·特殊

无尘系列

机械爪

耐切削液

防尘规格

无尘·特殊

无尘系列

机械爪

耐切削液

防尘规格

## 外形图

### ■BHA-04A-FC (最适合夹持力40N~110N)

#### BHA-04A-FC 标准

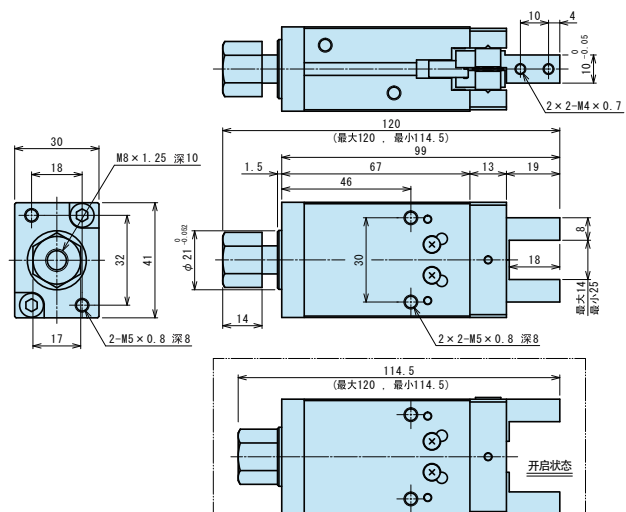

### ■BHA-05A-FC (最适合夹持力90N~150N)

#### BHA-05A-FC 标准

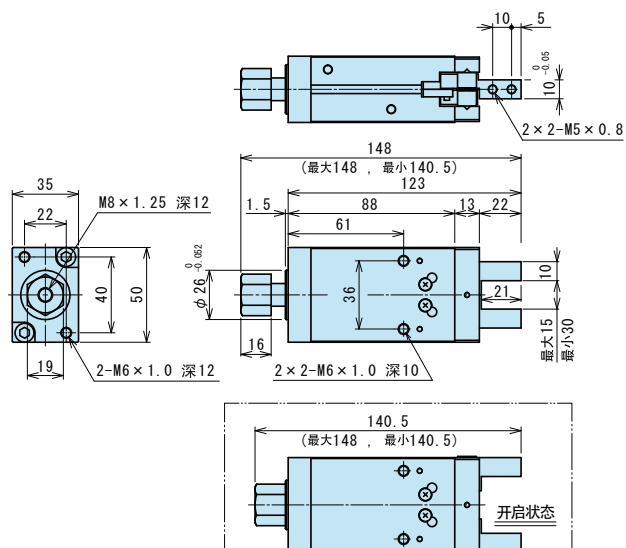

### ■BHA-06A-FC (最适合夹持力140N~200N)

#### BHA-06A-FC 标准

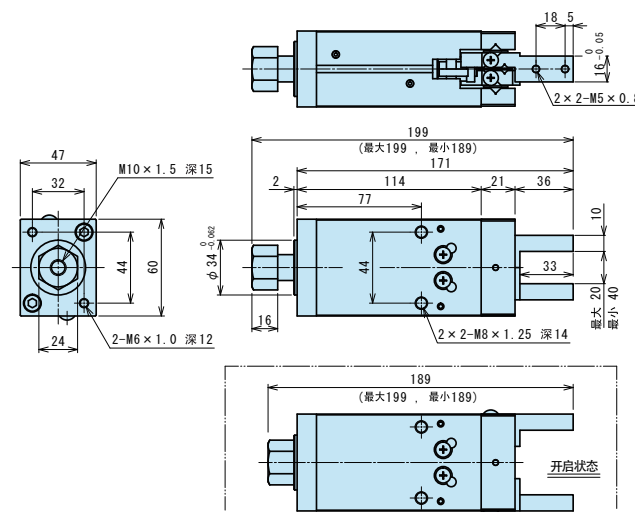

无尘·特殊

无尘系列

机械爪

耐切削液

防尘规格

无尘·特殊

无尘系列

机械爪

耐切削液

防尘规格